

## APPROACH

- Take Exit 41 off of US 23 onto Plymouth Road west.
- Travel west to Murfin (less than 2 miles) and turn left at traffic light.
- Travel four blocks and turn left at the Pierpont Commons Metered Visitors Lot and park.

### TO CHRYSLER CENTER

- Enter Pierpont Commons at north entrance or Chrysler Center at plaza (by Bev Pepper sculpture).
  - Enter Chrysler Center by North Campus Gallery to Chesebrough Auditorium lobby
- ### TO H.H. DOW BLDG.
- Cross the diag to the H.H. Dow Bldg and enter at the east entrance (to the right of the Alice Alcock sculpture).

**PARKING NOTE:** Visitors Lot is 50¢/hr. between the hours of 6 a.m. and 6 p.m. Parking violations at the University of Michigan carry a fine in excess of \$20.00 per occurrence.

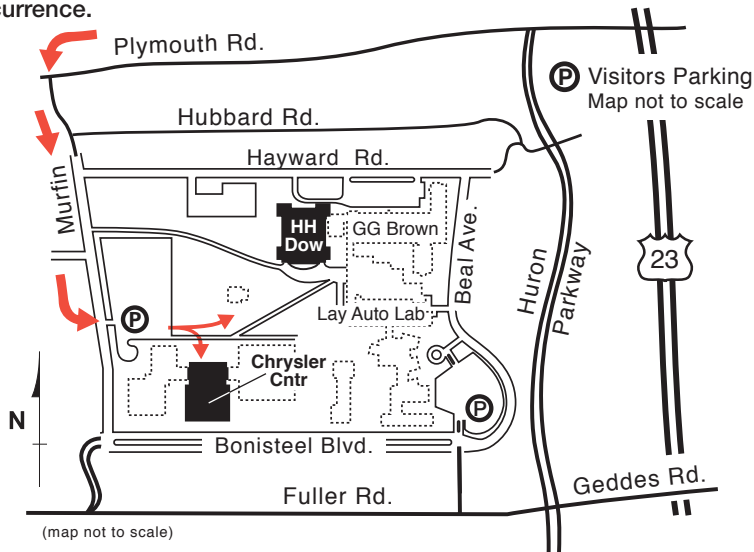

## Welcome to InterPro

Interdisciplinary Professional Programs  
at the University of Michigan

comprised of six related degree programs:

- **Automotive Engineering**
- **Financial Engineering**
- **Integrated Microsystems**
- **Pharmaceutical Engineering**  
—Chrysler Center
- **Global Automotive and Manufacturing Engineering**
- **Manufacturing Engineering**  
—H.H. Dow Building

## InterPro

University of Michigan College of Engineering  
273B Chrysler Center, 2121 Bonisteel Boulevard  
Ann Arbor, MI 48109-2092  
and

1542 H.H. DOW Building, 2300 Hayward St.  
Ann Arbor, MI 48109-2136

# InterPro

Administrative Offices  
are located at the:

Chrysler Center

—Gail Carr, 734-763-0480

and

H.H. Dow Building

—Kathy Bishar, 734-764-3312



H.H. Dow Building  
—Kathy Bishar, 734-764-3312

*H.H. Dow  
Bldg.*

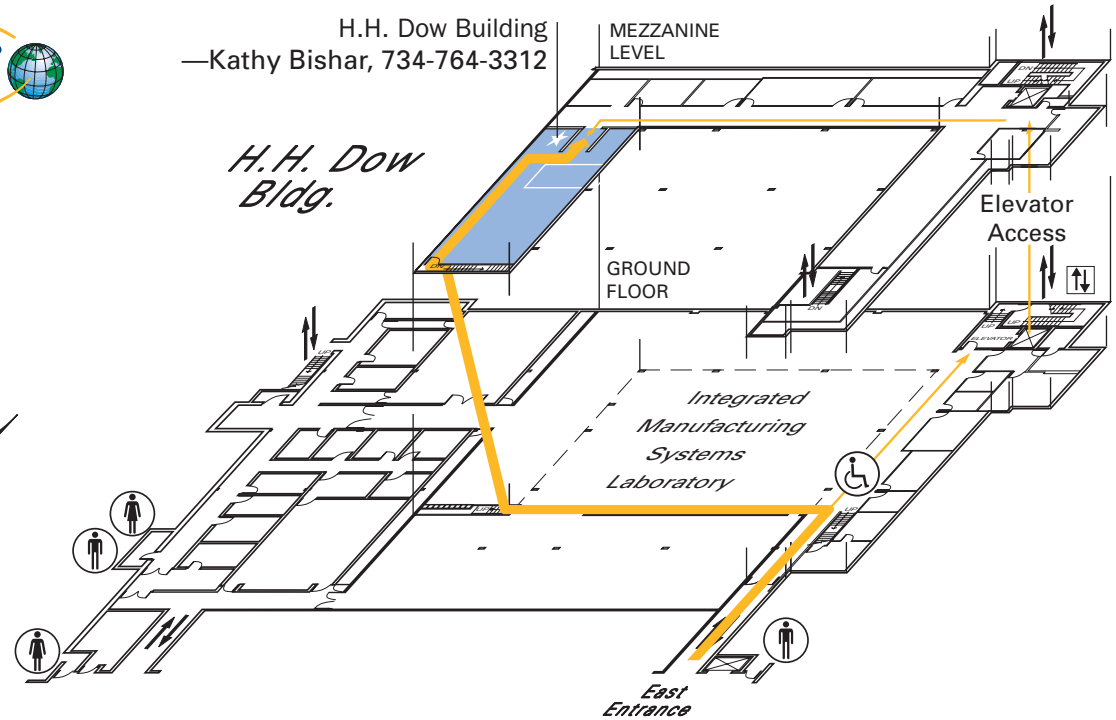

## Chrysler Center Office

- Enter Chrysler Center via corridors by North Campus Gallery.
- Cross Chesebrough lobby and enter Chrysler Center to the right of the auditorium.
- InterPro offices entrance is immediately to your right.

Chrysler Center  
—Gail Carr, 734-763-0480

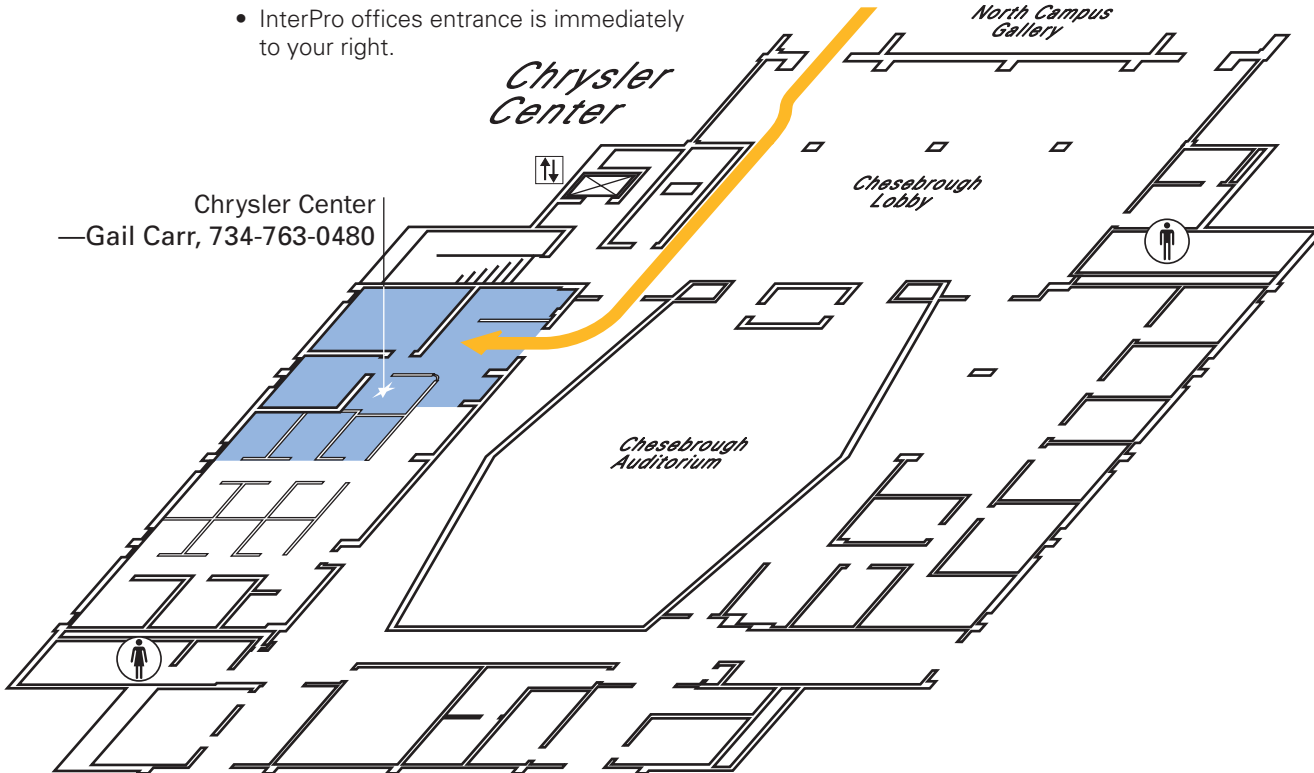

## H.H. Dow Office

- Enter at the east entrance of the Integrated Manufacturing Systems Laboratory.
- Turn left and proceed along the mural to the InterPro stairway entrance.
- Ascend the stairs and proceed north to the administrative offices.

### For Elevator Access

- Enter at the east entrance of the Integrated Manufacturing Systems Laboratory as above.
- Proceed north along the corridor to the elevator vestibule, and go up one level, to the Mezzanine (M) floor.
- Turn right and proceed west to the InterPro offices entrance.